

# LAKE BOREN PARK MASTER PLANNING

## Draft Summary Report

September 14, 2016







Fix me

fresh rain here

LAKE BOREN PARK MASTER PLANNING

PUBL 2016

MAINTAIN TRAIL (SAFE)

More doggy bags through the park

Thank you for the great covers in Borens retro room. I don't know how many more paper rental place would be great to have, but I will be the first to use it!

HABITAT - SMOOTHER BOARDWALK - ELEVATED WALKS (???)  
DOES EXISTING INCLUDE / IS LAKE ROOM (WHAT LIVES IN PARK OR DO)  
LAKE ACCESS (WALK IS GOOD)  
SHEIKERS - MORE WALKS  
NATURALIST REPAIRS  
BONUS KIDS PLAY - NATURE PLAY  
CLIMBING WALL  
OFF LEASH (20-100)  
POLE CLIMBING DECK  
COMMUNITY SPACE FOR MEAS/CLIMBS (SOME SUGGESTION)

Tribute board or wall to our mining history

More doggy bags through the park

Rea Patch

Small Skatepark Please!

Seasonal Ice skating

Great Community Feel To Don't Change

I Want a skate park

MAINTAIN TRAIL (SAFE)

Lake Bore

Property Recently Acquired by the City for Park expansion

CONVERT EAST TO WEST / READER  
MORE SEATING  
CLIMBING WALL (SOME FOR KIDS - SOME FOR ADULTS)  
SKEE RAGE  
DISC GOLF  
Nert Gun Area



# Contents

Project Introduction and History .....	1
Lake Boren Park Preferred Plan .....	2
Program Keynotes .....	4
Design Program .....	5
Key Principles .....	7
Park Views .....	8
Phasing & Cost Estimate .....	16
Public Outreach - Meetings .....	22
Public Outreach - Kiosk, Mailers & Survey .....	31
Appendix .....	34

## Acknowledgments

The Lake Boren Park Master Plan City and Consultant team would like to thank the following contributors for their varying and generous contributions in time, borrowed space, thoughtfulness, and funding:

*King County Flood Control District: Flood Reduction Grant*

*King County Conservation Futures Grant*

*The volunteer members of the City of Newcastle Community Activities Commission*

*Newcastle City Council*

*Newcastle Elementary*

*Seattle Revival Center*

*Hazelwood Elementary*

*The Citizens of the City of Newcastle*





## Project Introduction

Lake Boren Park is the largest city-owned park in Newcastle, Washington. The park is centrally located and serves as the primary destination for organized events and opportunities for play and relaxation.

This master plan responds to the community's changing needs and growth, as well as the park's expansion. The park is currently about 22 acres. The land purchased along Boren Creek in 2016 as well as connections along the east side increase the park to around 31 acres.







**Lake Boren Park Preferred Plan**







## Program Keynotes *(see preferred plan)*

### Infrastructure

- 01 Cross Park Lighting
- 02 Bioretention/Stormwater Facilities
- 03 Parking (reconfigured to 54 stalls)
- 04 Parking & Drop-off (added 76 stalls)
- 05 North Parking

### Park Core Amenities

- 06 Newcastle Plaza (seat-walls, 30'-wide paving)
- 07 Amphitheater (terraced with seat-walls & rock outcrops)
- 08 Stage at the Grove (covered)
- 09 Additional Restrooms
- 10 Plaza Trellis
- 11 Entry Signs
- 12 Cross Park Promenade
- 13 North Sweep Boardwalk and Picnic Pavilion
- 14 Beach Boardwalk
- 15 Beach
- 16 Community Garden
- 17 Shelter Improvements
- 18 Additional Tennis Court
- 19 Tool Storage
- 20 Picnic Area
- 21 Trees

### Boren Creek Collection

- 22 Boardwalk to Learning Center
- 23 Shelter (learning center)
- 24 Boren Creek Path (5' crushed rock)
- 25 Boren Creek Stairs
- 26 Boren Creek Bridge
- 27 Path around Parking
- 28 Off-leash Area (preferred location)
- 29 Off-leash Area (alternate location)
- 30 Native/Mitigation Planting

### Lake Boren Connection

- 31 Lake Boren Promenade (5' asphalt)
- 32 Lake Boren Promenade Boardwalk
- 33 Promenade Deck
- 34 Lake Boren Stairs
- 35 Lake Boren Dock
- 36 Accessible Lake Boren Connection

### Park-wide

- 37 Site Furnishings (benches, tables, bike racks, waste/recycling receptacles)
- 38 Park Identification

### Wetlands

- A Wetland A
- B Wetland B Boundary
- C Wetland C Boundary
- D Wetland D Boundary
- E Wetland E Boundary
- F Lake Boren
- G Boren Creek

#### *Wetland note:*

*The lake, stream and wetlands and their associated buffers have been identified but not delineated in a Wetland/Stream Reconnaissance Report prepared by The Watershed Company dated April 13, 2016. For the purposes of preparing the Master Plan, the lake, stream and wetland boundaries and associated buffers shown herein have been located approximately and should be used for general reference only.*



# Design Program

## Make the most of what you have

This master plan update is about making the most of the park as it exists today. The community embraces the park and all it has to offer, so much so that some participants during the input process didn't want to see any changes. This master plan update is not about changing the park but about improving what is already there, incorporating new park land and looking toward the future.

The existing highlights of the park include passive and active recreation, open space, connections to the water, gathering spaces, play opportunities, looped walkways, and trees. The master plan proposes to maintain these features and provide additional recreation opportunities. The performance stage will be upgraded along with a new location that allows more people the opportunity to be in front of the stage. Views and access to the water are improved, as well as new walkways and paths that take advantage of the newly acquired space along Boren Creek. The park is better connected to the Esplanade and east shore of the lake. Additional parking is proposed to accommodate the growing community and outdoor activity.





# Key Features

## Art in the Park

The inclusion of art within the park should be considered as a way to express the unique qualities of the park and community. Opportunities for art are throughout the park. Art opportunities can be found in the paving, structures, boardwalk, park identification, and discovery pieces along the pathways.

## Connections

The master plan is all about making connections to new and existing park features, trails, and neighborhoods.

Connections to the lake are improved in multiple ways. Access from the north park entrance to the existing dock is improved by an ADA-accessible path. New parking at the north entrance provides the opportunity to unload hand-carried watercraft with easy access to the water.

A new beach improves water access, along with an area to sit and gather. A proposed boardwalk connects the existing dock and beach. This boardwalk extends around the south end of the lake to the eastside dock. This new and long-desired connection crosses over water for a unique experience that includes seating and viewing areas. When it reaches land on the east side of the lake, it becomes the Lake Boren Promenade connecting to the northern reach of the park. It also provides a connection to SE 79th Street.

The cross-park promenade connects the south and north ends of the park. The renewed pedestrian entrance at the south, off SE 84th Way, provides a direct connection to the core of the park and the Newcastle Plaza. From the center of the park it extends north, making use of existing paths that provide access to the new amphitheater. The cross-park promenade is proposed to be lighted for safe access year-round.

The adjacent water line property will continue to benefit the park and community. While not owned by the city, it is a well-used connection to the park and an ideal temporary parking area during events. Accessible and paved paths provide safe, designated pedestrian routes from the water line property to the park.

## Newcastle Plaza

The Newcastle Plaza provides a location for gathering and vendors during all types of civic events. This centrally located gathering space is also the location of the restroom addition. The building and plaza are a way for Newcastle's history to be shared through displays, imagery, materials and unique detailing.

Another feature of the plaza is the community garden. This is the new location for the fuchsia garden with additional room for other outdoor displays both permanent and temporary. There is additional plaza space in this area for gathering, event set-up, and arrival from the expanded parking lot.

The parking lot is expanded to accommodate 130 vehicles. This adds to the existing 50-car lot. The parking is expanded over a stormwater vault placed within the existing stormwater detention pond.

## Amphitheater

In this plan, the stage is moved from its existing location to the north lawn. The stage is located near the base of the sloping lawn for better visibility and increased gathering space. The new amphitheater can easily accommodate about 1,500 people, which is approximately 500 more than the current location. The new stage location moves the performance activity downhill and slightly further from adjacent homes. It will be configured for events but will serve as shelter for other activities during a greater part of the year.



The amphitheater is a sloping lawn with terraces wide enough to spread out blankets or accommodate portable lawn furniture. Accessibility is improved through access to the middle of the gathering space. A unique feature of the amphitheater, which is a feature of the Newcastle area, is the rock outcrops. These will be an integral part and create seating and recreational opportunities. Lighting is proposed for the amphitheater to ensure safe exit.

## **Boren Creek**

The Boren Creek area includes the recently acquired property. The existing houses are to be removed and the space adapted to new park uses. The northern-most home site becomes a gathering space within the existing forest. The feature of this area is the existing large and mature trees, which create a unique space for a new shelter and opportunities to view the lake and adjacent wetland.

New paths through the Boren Creek area allow park visitors a unique experience of walking along the creek and through the forested wetland. The new paths connect to existing paths to create a network that crosses the creek at existing and proposed bridge locations.

The location of the southern house is an option for the off-leash area. This area is about an acre and situated between an existing rock retaining wall and Boren Creek. The location is off the beaten path and becomes a destination for those seeking a place for their dog to play.

## **Let's Play**

The active recreation opportunities remain. Basketball, sand volleyball, and tennis are at the center of the park. Tennis gets a boost through the addition of one court for a total of three. The children's play area remains as it currently exists with a wide variety of play events for all ages. It is well used and liked, and no improvements were requested as part of this update.

The opportunity for play is increased through relocating the stage to the north. Concert and event attendees will gather in the new amphitheater, and the lawn east of the play area will be regraded to make it more usable. Each activity will benefit by having a separate area. During large events, such as the 4th of July celebration, the lawn area will be available to accommodate the greater number of attendees.

## **Off-Leash Area**

The off-leash area has been a highly debated subject. Input received during this planning process was split between people in favor and people against. Two options for the location are proposed.

One alternative location that was previously mentioned is in the newly acquired area away from most park activity. This location is separated from the higher-use areas of the park by elevation change and a rock retaining wall, and most park users will not be aware of its existence. It is a clearing in the woods due to the house that occupied the space for many years.

The other location is in the southwest corner of the park in an unused area with a stand of trees, including Big Leaf Maples and Alders, and undergrowth of blackberries. The area is bowl-like with slopes to the west and north. The sloped areas create separation from the neighbors across the water line property to the west and the park to the north. The proximity to the parking lot and park paths makes this area an option worth considering.



## Park Views



View 1 Beach and boardwalk

Proposed lake access at a beach with areas to sit and relax. Lakeside vegetation is maintained to open up views of the lake and existing dock.





Existing condition





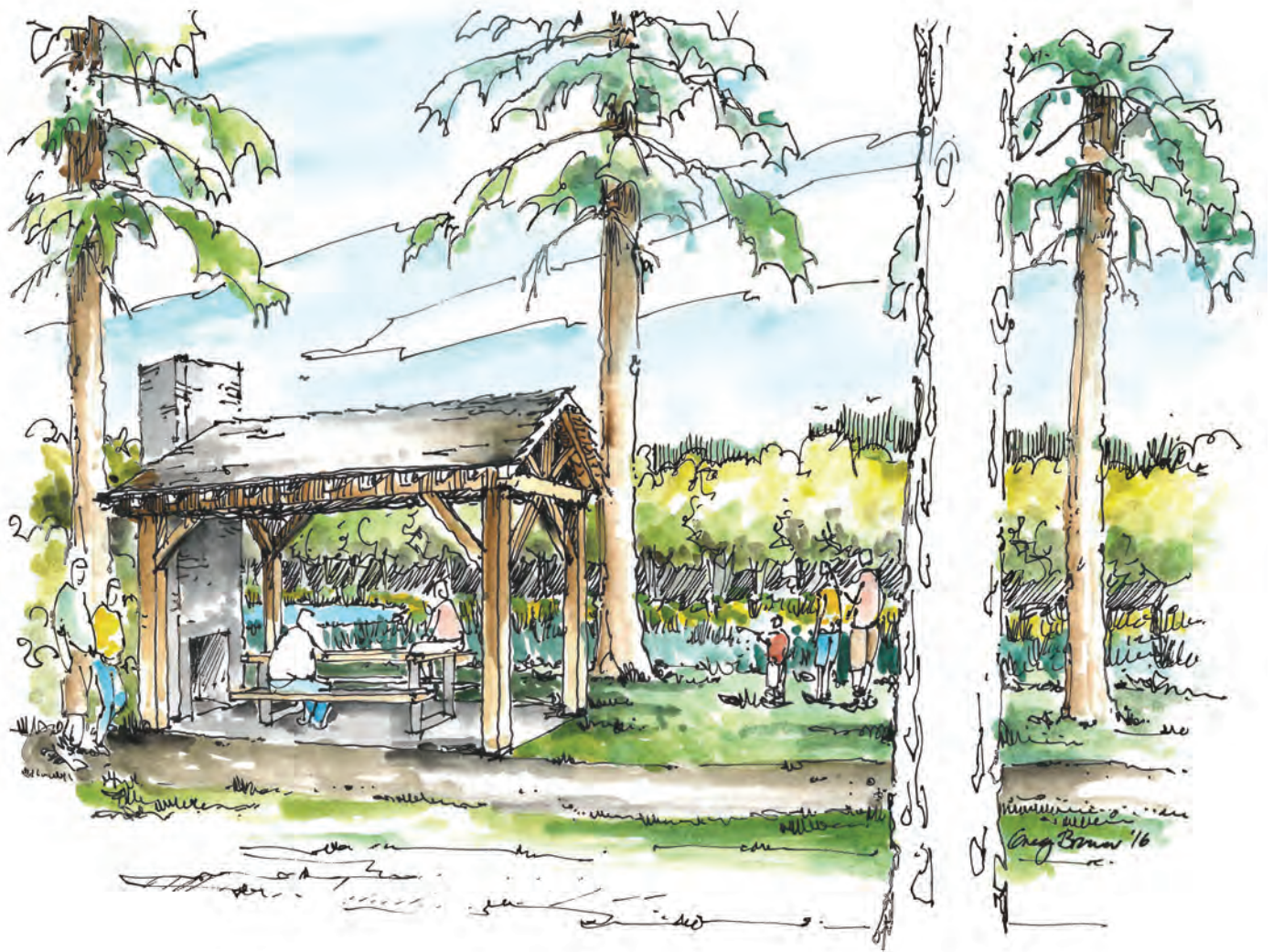

View 2 Shelter and learning center

A shelter near the south end of the lake provides a place for views of the lake and wetlands. The fireplace from the existing house could become part of the shelter.





Existing condition







View 3 Amphitheater terraced with seat-walls and rock outcrops

The amphitheater has terraces for seating. Rock outcrops create unique perches and express the geology that defines Newcastle. The Grove Shelter and stage is set next to an existing stand of trees.



Existing condition







View 4 Promenade and Plaza

The Newcastle Plaza is at the center of the park and the gathering place for the community. It is a place for activity and for vendors to set up during special events.





Existing condition







View 5 Lake Boren Promenade

The Lake Boren Promenade winds along the east shore of the lake. It allows pedestrians to get close to the water and provides a connection to the dock, promenade deck, and the Lake Boren stairs at the north end of the park.





Existing condition





# Phasing & Cost Estimate

## Phase A: Amphitheater

This phase includes relocating and improving the stage, including a permanent stage structure that can be used as a picnic shelter during non-event times. This phase also includes the cross-park promenade, Newcastle Plaza, north and south park entries, and improved access to the pipeline right-of-way.



	Quantity	Unit	Unit Cost	Total
Site Preparation	5	A	30,000.00	150,000
Amphitheater - terraced, lighting	50,000	SF	6.00	300,000
Stage at the Grove - Conc. pad, structure, power		Allow	140,000.00	140,000
Newcastle Plaza - Conc. paving and seat walls	7,000	SF	22.00	154,000
Cross-park promenade (10' asphalt)	1,400	LF	85.00	119,000
Cross-park promenade lighting - 28 fixtures	28	EA	6,250.00	175,000
North parking - 3 stalls, drive aisle, turn around	3	EA	21,500.00	64,500
North and south park entries and signs	2	EA	10,000.00	20,000
Off leash area (optional location)	50,000	SF	5.00	250,000
Shelter - improvements to existing	2	EA	15,000.00	30,000
Site furnishings		Allow	20,000.00	20,000
Planting and irrigation	5	A	130,000.00	650,000

**Subtotal** **\$2,072,500**

Taxes (9.5%) \$196,888

Design Fees (12%) \$248,700

**Total** **\$2,518,088**

## Phase B: Beach

This phase includes creating a beach area at the lake, gathering spaces, a shelter, improved access from the north entry to the lake, and a connecting boardwalk around the south end of the lake.



	Quantity	Unit	Unit Cost	Total
Site Preparation	1.20	A	30,000.00	36,000
Boardwalk - North sweep	1,500	SF	70.00	105,000
Boardwalk at the Beach	2,200	SF	70.00	154,000
Beach	6,000	SF	12.00	72,000
Lake Boren Promenade Boardwalk (south)	3,000	SF	90.00	270,000
Site furnishings		Allow	15,000.00	15,000
Planting and irrigation	1.20	A	130,000.00	156,000
<b>Subtotal</b>				<b>\$808,000</b>
Taxes (9.5%)				\$76,760
Design Fees (12%)				\$96,960
<b>Total</b>				<b>\$981,720</b>

\* Phases represent proposed groupings, are not in order of priority or proposed sequence.



## Phase C: Boren Creek

This phase includes improvements to the recently acquired parcels. A forest shelter is included along with an off-leash area, connecting paths adjacent to the creek, and improved access from the existing park paths.

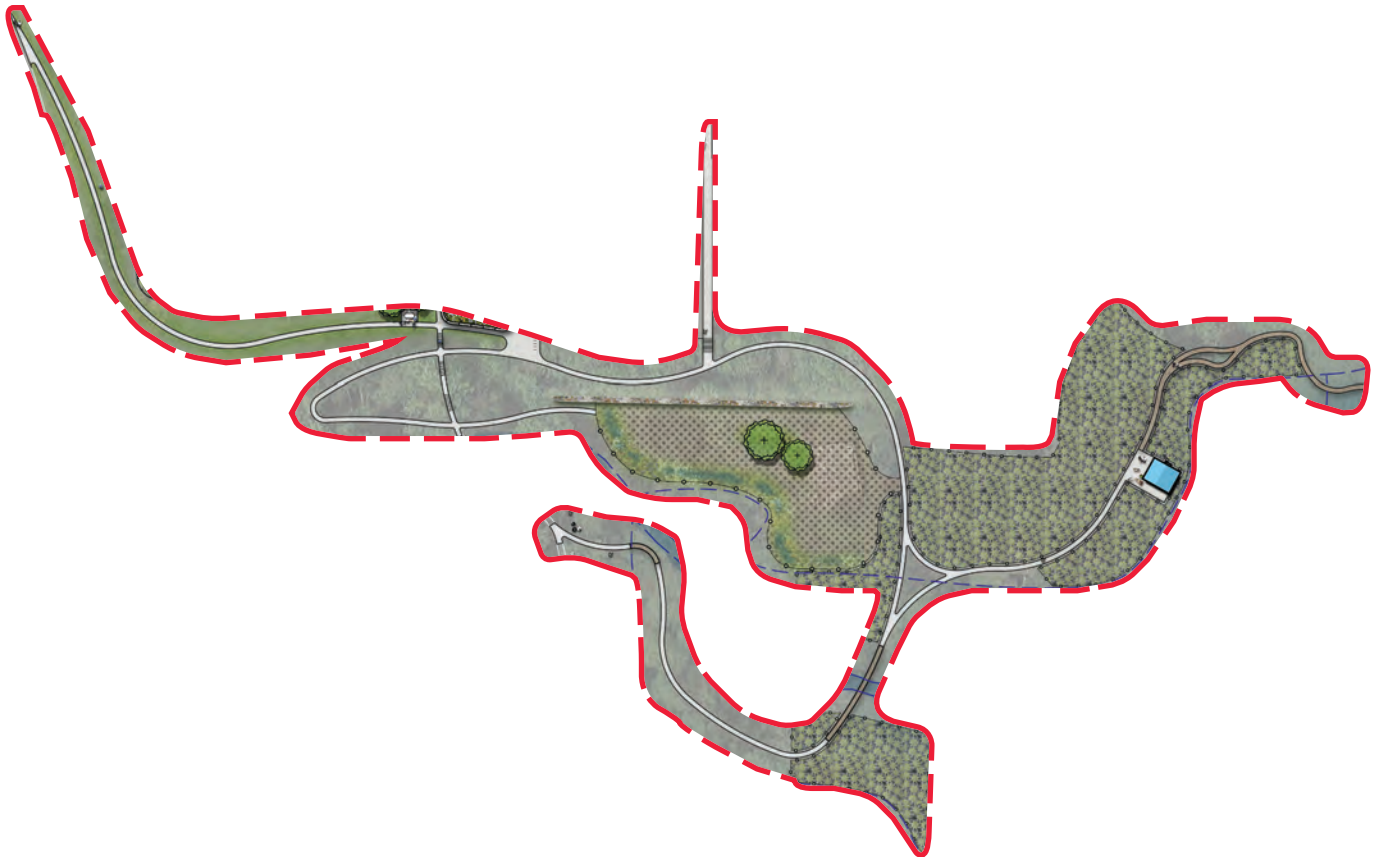

	Quantity	Unit	Unit Cost	Total
Site Preparation	2	A	30,000.00	60,000
Boardwalk to Learning Center	2,100	SF	70.00	147,000
Shelter - Learning Center		Allow	100,000.00	100,000
Boren Creek path (5' crushed rock)	1,600	LF	30.00	48,000
Boren Creek stairs	150	LF	160.00	24,000
Boren Creek bridge	480	SF	100.00	48,000
Path around parking (5' crushed rock)	600	LF	30.00	18,000
Off leash area (optional location)	50,000	SF	5.00	250,000
Invasive Species Removal		Allow		25,000
Native/mitigation planting	90,000	SF	5.00	450,000
Rockery railing (4' ht chain link)	250	LF	35.00	8,750
Site furnishings		Allow	10,000.00	10,000
<b>Subtotal</b>				<b>\$1,188,750</b>
Taxes (9.5%)				\$112,931
Design Fees (12%)				\$142,650
<b>Total</b>				<b>\$1,444,331</b>

## Phase D: Lake Boren Connection

This phase includes additional access to the east side of the lake. The Lake Boren promenade provides an alternate walking experience from the Esplanade and connects the boardwalk (Phase B), the dock, the promenade deck, and Lake Boren stairs. This phase also completes the cross-park trail that connects to neighborhoods to the east.

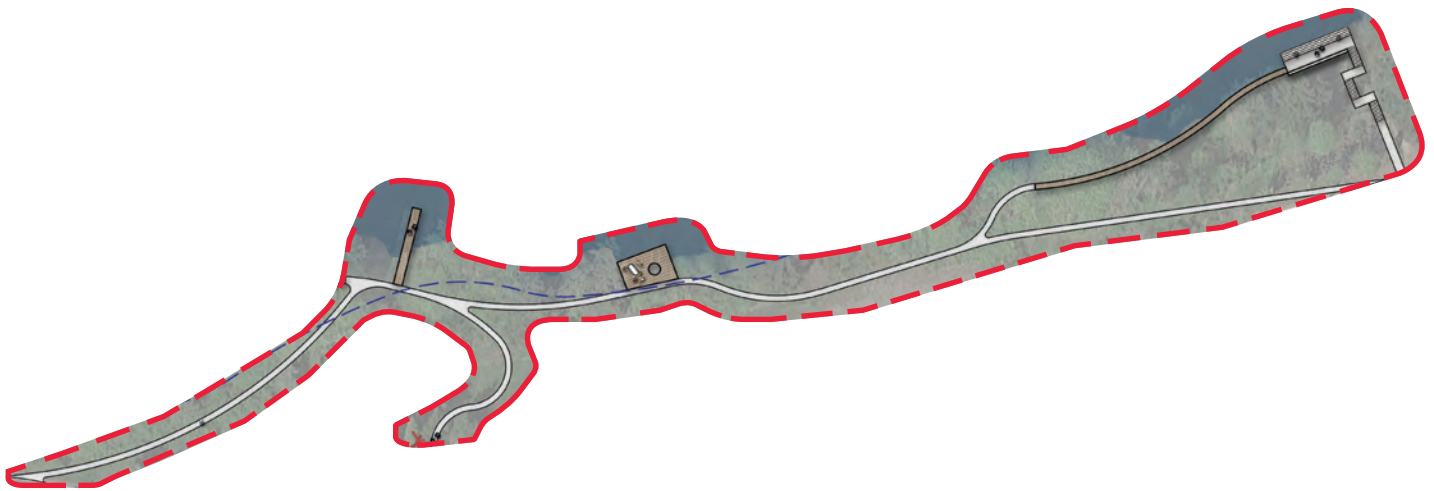

	Quantity	Unit	Unit Cost	Total
Site Preparation	4	A	30,000.00	120,000
Lake Boren Promenade - (5' asphalt)	800	LF	40.00	32,000
Lake Boren Promenade boardwalk (north)	950	SF	90.00	85,500
Promenade deck - rebuilt	300	SF	90.00	27,000
Lake Boren stairs - rebuilt	200	LF	160.00	32,000
Invasive Species Removal		Allow		15,000
Native/mitigation planting	50,000	SF	5.00	250,000
Site furnishings		Allow	15,000.00	15,000
Native planting, no irrigation	25,000	SF	2.00	50,000
<b>Subtotal</b>				<b>\$626,500</b>
Taxes (9.5%)				\$59,518
Design Fees (12%)				\$75,180
<b>Total</b>				<b>\$761,198</b>

\* Phases represent proposed groupings, are not in order of priority or proposed sequence.



## Phase E: Parking Expansion

This phase includes improving and expanding the existing parking lot. An underground stormwater storage and treatment vault is located under the east half of the parking lot.



	Quantity	Unit	Unit Cost	Total
Site Preparation		Allow		200,000
Stormwater storage, conveyance, treatment		Allow		850,000
Parking expansion to 139 stalls	65	Stall	3,000.00	195,000
Lighting	8	EA	8,000.00	64,000
Site furnishings		Allow		15,000
Planting and irrigation	20,000	SF	6.00	120,000
<b>Subtotal</b>				<b>\$1,444,000</b>
Taxes (9.5%)				\$137,180
Design Fees (12%)				\$173,280
<b>Total</b>				<b>\$1,754,460</b>



## Phase F: Entry Plaza

This phase includes restroom expansion, park plaza, community garden, and additional tennis court.



	Quantity	Unit	Unit Cost	Total
Site Preparation	2	A	40,000.00	80,000
Restroom expansion		Allow		750,000
Park plaza	8,000	SF	22.00	176,000
Plaza trellis	750	SF	120.00	90,000
Community garden	1,500	SF	20.00	30,000
Additional tennis court		Allow		225,000
Site furnishings		Allow		25,000
Planting and irrigation	12,500	SF	8.00	100,000
<b>Subtotal</b>				<b>\$1,476,000</b>
Taxes (9.5%)				\$140,220
Design Fees (12%)				\$177,120
<b>Total</b>				<b>\$1,793,340</b>

*\* Phases represent proposed groupings, are not in order of priority or proposed sequence.*

Grand Total



Subtotal Phase A	\$2,072,500
Subtotal Phase B	\$808,000
Subtotal Phase C	\$1,188,750
Subtotal Phase D	\$626,500
Subtotal Phase E	\$1,444,000
Subtotal Phase F	\$1,476,000
<b>Subtotal</b>	<b>\$7,615,750</b>

Tax (9.5%)	\$723,496
Design Fee (12%)	\$913,890

<b>Total</b>	<b>\$9,253,136</b>
--------------	--------------------

- Inclusions**
- Contingency (20%)
  - General Conditions (10%)
  - Contractor Overhead (8%)
  - Contractor Profit (8%)

- Exclusions**
- Demolition and restoration of acquired parcels
  - Fishing dock repair
  - Utility upgrades, if necessary
  - Park maintenance
  - Permits







42,000 SF

**Existing Amphitheater:**

**43,000 SF / 40 SF per person = 1,075**





**Proposed Amphitheater:**  
**48,000 SF / 40 SF per person = 1,550**

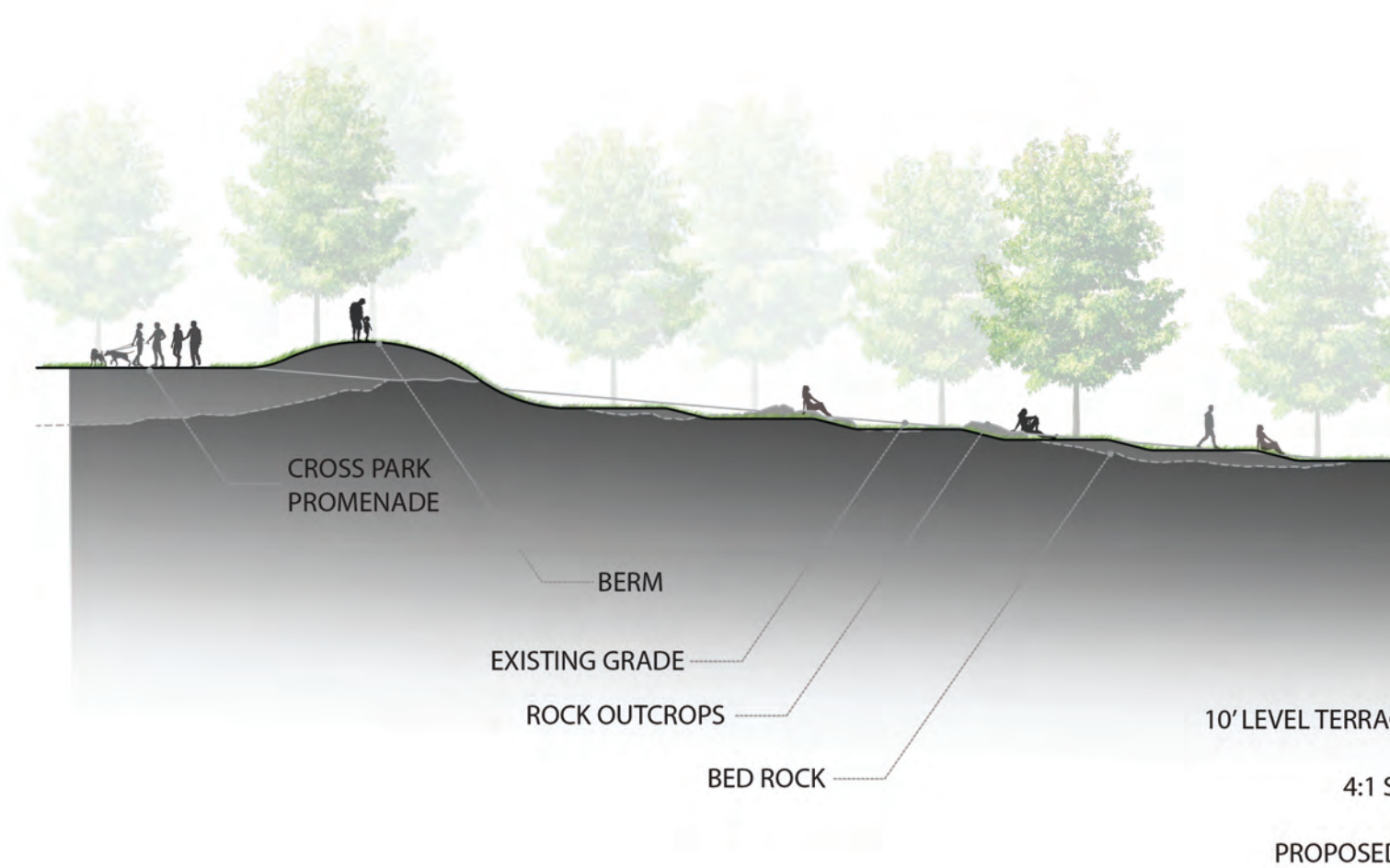

## AMPHITHEATER SECTION A-A



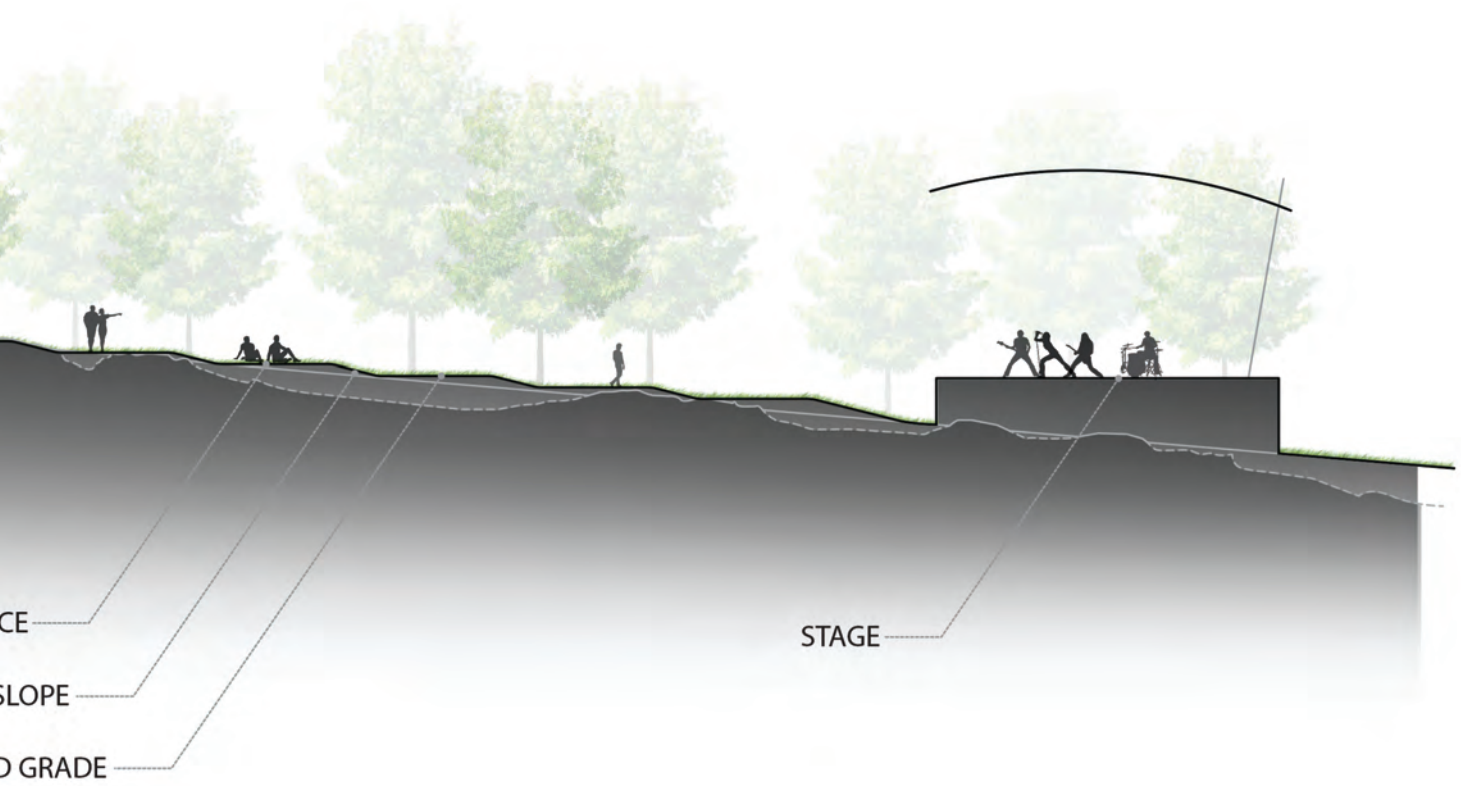

# Public Outreach Process

The Master Plan process included a robust public outreach process involving multiple types of outreach. The process centered around public meetings but also utilized a mailer, online surveys, an input kiosk in the park, and fliers. Below is a diagram showing the components of the process and where they occurred in the from Site Analysis to Concept Design to Master Plan development.

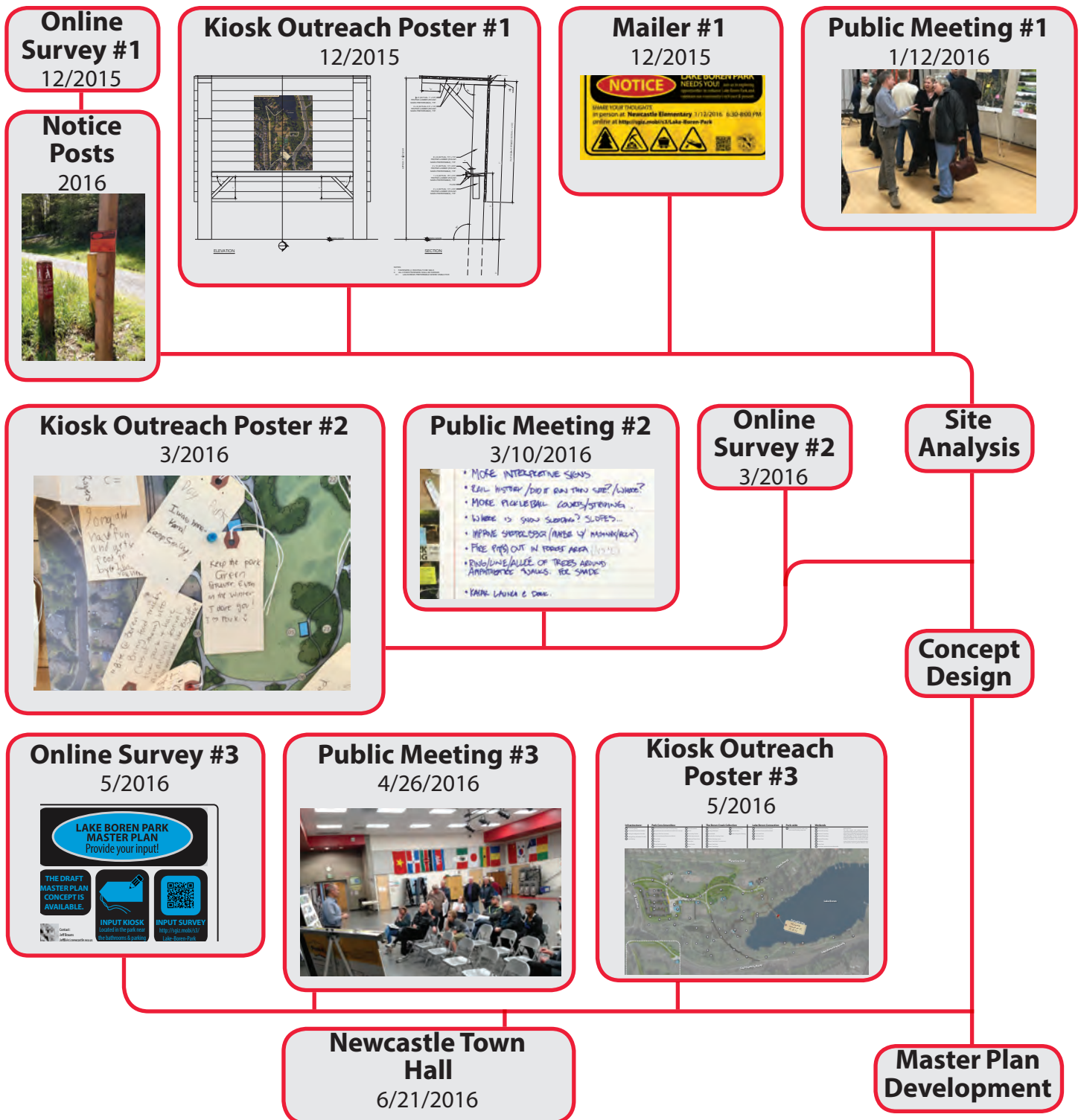



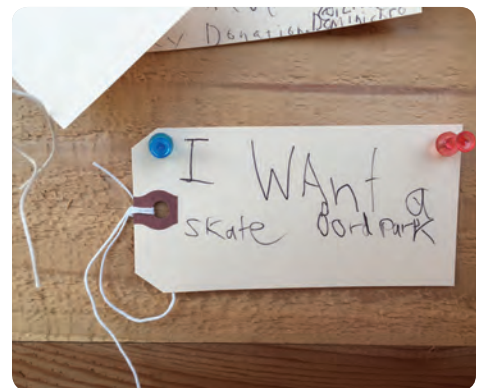
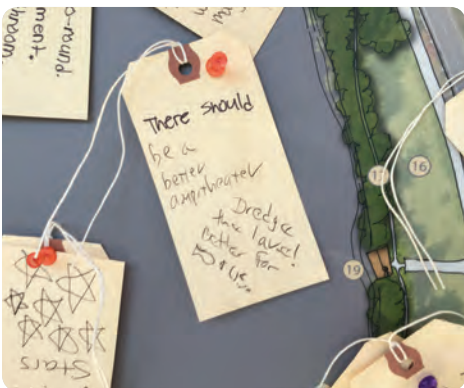





Small Skatepark Please!

Fix me

fresh rain here

LAKE BOREN PARK WATER PLANNING

More doggy bags through the park

Thank you for the best covers in history

HABITAT - SNORKEL BOARDWALK - ELEVATED WALKS (30')  
QUEST EXISTING INCLUDE / IS LAKE (some what used in park or do)  
LAKE ACCESS (what is good)  
SHEIKERS - more water  
WATERCRAFT RENTALS  
BOATERS - more water  
CLIMBING WALL  
OFF LEASH (30-100)  
POLE CLIMBING DECK  
COMMUNITY SPACE FOR MEETINGS (some suggestions)

More doggy bags through the park

Thank you for the best covers in history

Rea Patch

Rea Patch

Small Skatepark Please!

Great Community Feel To Don't Change

Great Community Feel To Don't Change

LAKE BOREN PARK NEEDS YOU

LAKE BOREN PARK NEEDS YOU

I Want a Skate Court

MAINTAIN TRAIL (SAFE)

Property Recently Acquired by the City for Park expansion

Property Recently Acquired by the City for Park expansion

CONVERT EAST TO WEST / READER

CONVERT EAST TO WEST / READER

CONVERT EAST TO WEST / READER

LAKE BOREN PARK NEEDS YOU

LAKE BOREN PARK NEEDS YOU

LAKE BOREN PARK NEEDS YOU

LAKE BOREN PARK NEEDS YOU

LAKE BOREN PARK NEEDS YOU



# Kiosk Tag Summary

## Total Comments

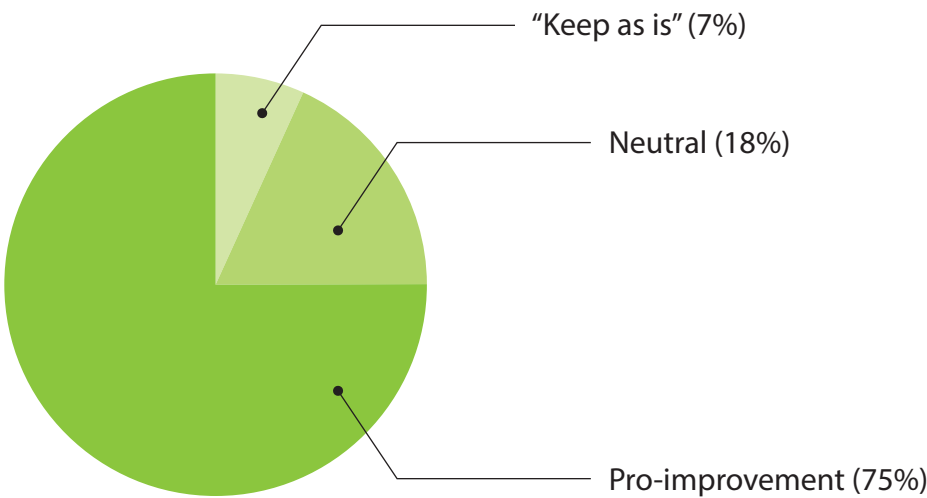

## Top Improvements

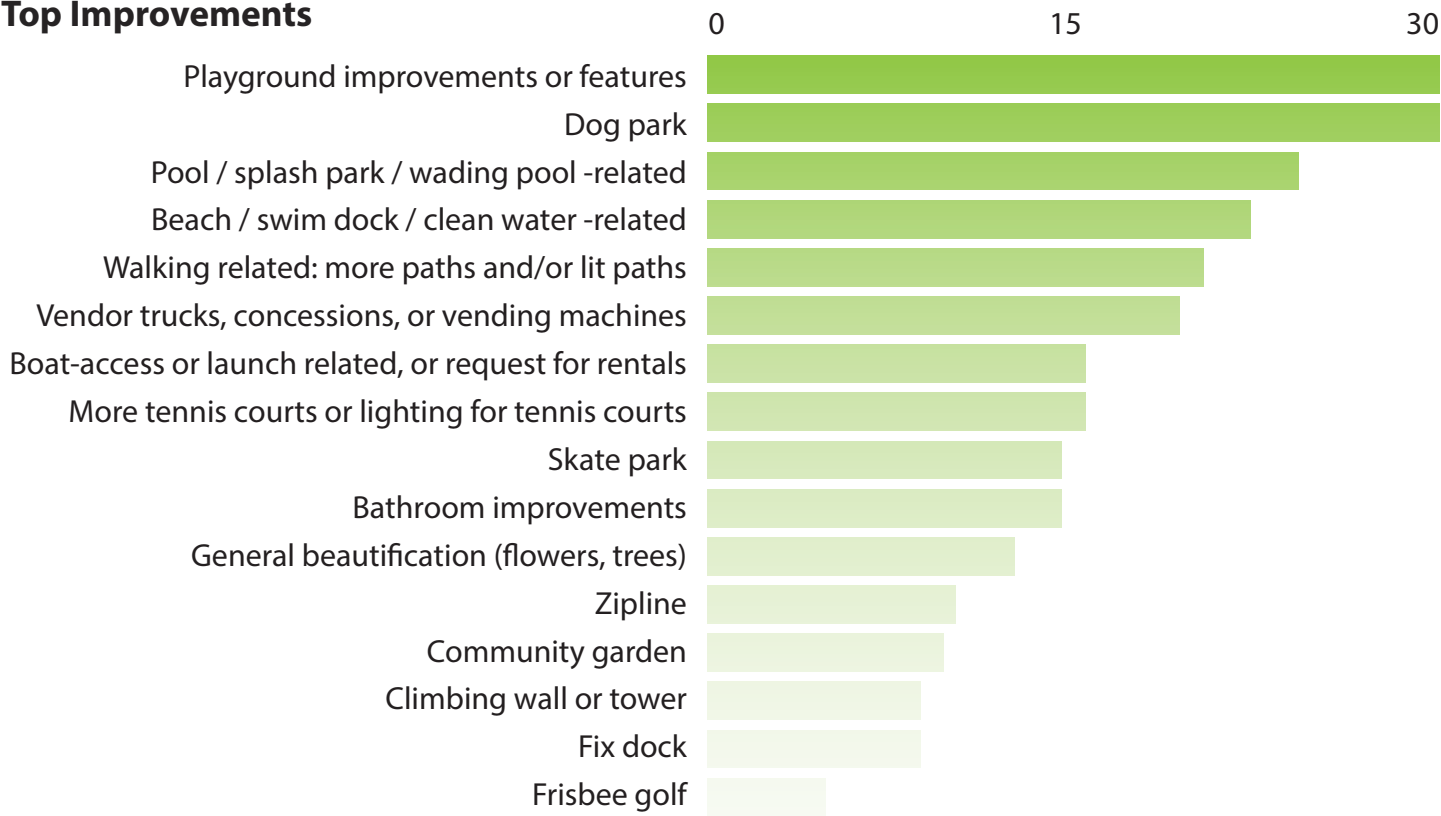

*\* To see complete summary of kiosk tags, please refer to Appendix B.*

## Public Survey 1 Summary

This survey asked residents questions about the existing park such as what are their favorite elements and activities.







## CONCEPT 'A'

- 01 ACCESSIBLE PATH CONNECTION
- 02 MINING PLAY/LEARNING AREA & LEVEL PLAY LAWN
- 03 NEWCASTLE PLAZA & FESTIVAL TENTS (EPHEMERAL)
- 04 OPPORTUNITY AREA (DOG PARK, SKATE PARK)
- 05 STAGE & AMPHITHEATER BOWL W/ OUTCROPS
- 06 ACCESSIBLE PRIMARY PATH NETWORK
- 07 FERN, MOSS & ROCK GARDEN
- 08 PARK ENTRANCE W/ PARKING
- 09 MAINTENANCE FACILITY SCREENING
- 10 REBUILT DOCK
- 11 TRESTLE BOARDWALK & NATURAL BEACH
- 12 RELOCATED STRUCTURE AND FOREST MEADOW
- 13 ACCESSIBLE SECONDARY PATH NETWORK
- 14 OUTCROP VIEWPOINT
- 15 NATURAL BEACH
- 16 OPPORTUNITY AREA (DOG PARK, SKATE PARK)
- 17 LAKESIDE PROMENADE
- 18 REBUILT DOCK
- 19 REBUILT DOCK PLATFORM
- 20 STAIR CONNECTION TO EXISTING CONCRETE STEPS
- 21 IMPROVED SHELTER AMENITIES
- 22 NATIVE PLANT RESTORATION AREA
- 23 RAIN GARDEN/SWALE

PLAN SHOWN AS  
'CONCEPT A' INCLUDED  
WITH PUBLIC SURVEY 2

Share your vision,  
idea and feedback!

## SHARE YOUR VISION

We're here to share concepts and listen to your feedback/ideas. Please leave your mark.  
1. Grab a pen and paper tag/post-it.  
2. Write down your thoughts on the concepts, what you love most about the park or what you would most like to see here.  
3. Pin your tag/post-it on any poster

## LAKE BOREN PARK MASTER PLANNING

PUBLIC MEETING NO.2  
2016/03/10





## Public Survey 2 Summary

**Rank your top three favorite elements from Concept A.**

Rank	Item	Score	Total Respondents
1	(17) Lakeside promenade	38	19
2	(5) Stage & amphitheater bowl with outcrops	38	17
3	(11) Trestle boardwalk & natural beach	36	17
4	(4) Opportunity area (dog park, skate park)	26	12
5	(2) Mining play/learning area & level play lawn	24	10
6	(10) Rebuilt dock	19	11
7	(6) Accessible primary path network	18	7
8	(8) Park entrance with parking	18	10
9	(13) Accessible secondary path network	17	10
10	(7) Fern, moss & rock garden	14	6
11	(15) Natural beach	14	8
12	(18) Rebuilt dock	14	7
13	(22) Native plant restoration area	11	7
14	(3) Newcastle plaza & festival tents (ephemeral)	11	5
15	(1) Accessible path connection	11	5
16	(16) Opportunity area (dog park, skate park)	10	6
17	(21) Improved shelter amenities	9	5
18	(14) Outcrop viewpoint	7	4
19	(19) Rebuilt dock platform	6	3
20	(12) Relocated structure and forest meadow	4	3
21	(23) Rain garden/swale	4	2
22	(20) Stair connection to existing concrete steps	3	2
23	(9) Maintenance facility screening	2	1

*\* To see full survey results, please refer to Appendix B.*

## CONCEPT 'B'

- 01 PARK ENTRANCE & CROSSWALK
- 02 ACCESSIBLE SECONDARY PATH NETWORK
- 03 ACCESSIBLE PRIMARY PATH NETWORK
- 04 ACCESSIBLE PATH CONNECTION
- 05 EXPANDED PARKING
- 06 RAIN GARDEN/WALE
- 07 ACCESSIBLE RAMPED PATHWAY
- 08 EXPANDED SPORTS COURTS
- 09 UNDERGROUND STORMWATER VAULT
- 10 IMPROVED SHELTER AMENITIES
- 11 MINING PLAY/LEARNING TERRACES
- 12 HILLSIDE SLIDES
- 13 MINING ROCK SCRAMBLE
- 14 LEVEL PLAY LAWN
- 15 COMMUNITY CENTER
- 16 NEWCASTLE PLAZA & FESTIVAL TENTS (EPHEMERAL)
- 17 FOREST EDGE LAWN / COMMUNITY GARDEN
- 18 CANOPY WALK/TRESTLE
- 19 ADVENTURE PATH
- 20 OUTDOOR LIVING ROOM STRUCTURE
- 21 FERN, MOSS & ROCK GARDEN
- 22 STONE STEPS
- 23 STAGE
- 24 AMPHITHEATER BOWL W/ OUTCROPS
- 25 MAINTENANCE FACILITY SCREENING
- 26 TURNAROUND PARK ENTRANCE W/ PARKING
- 27 FOREST ROOM
- 28 REBUILT DOCK
- 29 NATURAL SWIM BEACH
- 30 GATHERING AREA
- 31 NATIVE PLANT RESTORATION AREA
- 32 TRESTLE BOARDWALK
- 33 OPPORTUNITY AREA (DOG PARK, SKATE PARK)
- 34 CABLED BOAT CROSSING
- 35 NATURAL BEACH
- 36 LAKESIDE PROMENADE
- 37 REBUILT DOCK
- 38 REBUILT DOCK PLATFORM
- 39 STAIR CONNECTION TO CONCRETE STEPS

PLAN SHOWN AS  
'CONCEPT B' INCLUDED  
WITH PUBLIC SURVEY 2

Share your vision,  
idea and feedback!

## SHARE YOUR VISION

We're here to share concepts and listen to your feedback/ideas. Please leave your mark.  
1. Grab a pen and paper tag/post-it.  
2. Write down your thoughts on the concepts, what you love most about the park or what you would most like to see here.  
3. Pin your tag/post-it on any poster

## LAKE BOREN PARK MASTER PLANNING

PUBLIC MEETING NO.2  
2016/03/10





## Public Survey 2 Summary

**Rank your top three favorite elements from Concept B.**

Rank	Item	Score	Total Respondents
1	(29) Natural swim beach	33	15
2	(8) Expanded sports courts	24	9
3	(36) Lakeside promenade	23	12
4	(32) Trestle boardwalk	23	13
5	(15) Community center	20	9
6	(33) Opportunity area (dog park, skate park)	20	8
7	(11) Mining play/learning terraces	18	8
8	(19) Adventure path	16	9
9	(5) Expanded parking	6	8
10	(24) Amphitheater bowl with outcrops	16	8
11	(12) Hillside slides	14	7
12	(23) Stage	13	6
13	(4) Accessible path connection	12	5
14	(9) Underground stormwater vault	9	5
15	(3) Accessible primary path network	8	3
16	(2) Accessible secondary path network	8	5
17	(13) Mining rock scramble	7	4
18	(26) Turnaround park entrance with parking	7	5
19	(31) Native plant restoration area	7	4
20	(21) Fern, moss & rock garden	6	3
21	(10) Improved shelter amenities	6	3
22	(28) Rebuilt dock	5	3
23	(37) Rebuilt dock	4	2
24	(17) Forest edge lawn / community garden	4	2
25	(6) Rain garden/swale	4	2
26	(34) Cabled boat crossing	3	3
27	(18) Canopy walk trestle	3	1
28	(39) Stair connection to concrete steps	3	2
29	(20) Outdoor living room structure	3	2
30	(16) Newcastle plaza & festival tents (ephemeral)	2	1
31	(25) Maintenance facility screening	2	1
32	(30) Gathering area	1	1
33	(14) Level play lawn	1	1
34	(38) Rebuilt dock platform	1	1

*\* To see full survey results, please refer to Appendix B.*





## Public Survey 3 Summary

**Rank your top three favorite elements from Draft Master Plan Concept.**

<b>Rank</b>	<b>Item</b>	<b>Score</b>
1	(7 & 8) Amphitheater & Stage	113
2	(15) Beach	86
3	(31) Off-leash Area	72
4	(4) Expanded Parking	51
5	(14) Beach Boardwalk	45
6	(22 & 23) Canopy Walk Trestle & Span	44
7	(21) Trees	41
8	(37) Lake Boren Dock	27
9	(17) Picnic Shelter Improvements	27
10	(33) Lake Boren Promenade	26
11	(5) North Parking	21
12	(13) North Sweep Boardwalk	21
13	(12) Cross Park Promenade	19
14	(18) Additional Tennis Court	18
15	(34) Lake Boren Boardwalk	17
16	(27) Boren Creek Path	14
17	(9) Community Room(s)	14
18	(26) Shelter (Learning Center)	12
19	(19) Skate Spot	11
20	(25) Boardwalk to Learning Center	10
21	(24) Cattail Walk	9
22	(16) Community Garden	8
23	(6) Newcastle Plaza	8
24	(29) Boren Creek Bridge	8
25	(36) Lake Boren Stairs	7
26	(35) Promenade Deck	7
27	(10) Plaza Trellis	5
28	(20) Stone Garden	4
29	(30) Path around Parking	2
30	(28) Boren Creek Stairs	0

*\* To see full survey results, please refer to Appendix B.*

# Appendix

## Appendix Vol. 1

A: Master Planning Project Schedule

B: Public Survey Results

C: Kiosk Tag Results/Summary

## Appendix Vol. 2

D: Lake Boren Park, Permitting Memorandum

E: Lake Boren Park, Wetland/Stream Reconnaissance Report

## Appendix Vol. 3

F: SEPA Checklist





